

QUEEN STREET MALL

LEGEND

- FLAGSHIP STORES
- FASHION
- EUROPEAN
- GENERAL RETAIL
- LEISURE
- FOOD
- STORAGE
- PUBLIC LIFTS
- SERVICE LIFTS
- SEATING

LEGEND - STAGE 2 FF&E

FURNITURE & JOINERY

C1	GENERAL CHAIR	539 (549 - 10)
C2	STOOL	25
T1	TABLE LARGE - 4 / 5 SEATER	34 (36 - 2)
T2	TABLE LARGE - 4 / 5 SEATER	36
T3	TABLE SMALL - 2 SEATER	149
T5	SIDE TABLE - HOLLOW PRISM	4
J1	JOINERY - SPINE	75 SEATS / 50.3 LINEAL METRES
J4	JOINERY - DRY BAR	19 LINEAL METRES APPROX.
J5	JOINERY - LEDGE SEAT	8 SEATS / 7 LINEAL METRES APPROX.
J6	JOINERY - DOUBLE RUBBISH BIN	6

SEATING CAPACITY SURVEY

REF.	SEATING TYPE	QTY	%
C1	GENERAL CHAIR	539	84
C2	STOOL	25	4
J1	JOINERY - SPINE	75	11
J5	JOINERY - LEDGE SEAT	8	1
TOTAL CAPACITY		647	100 %

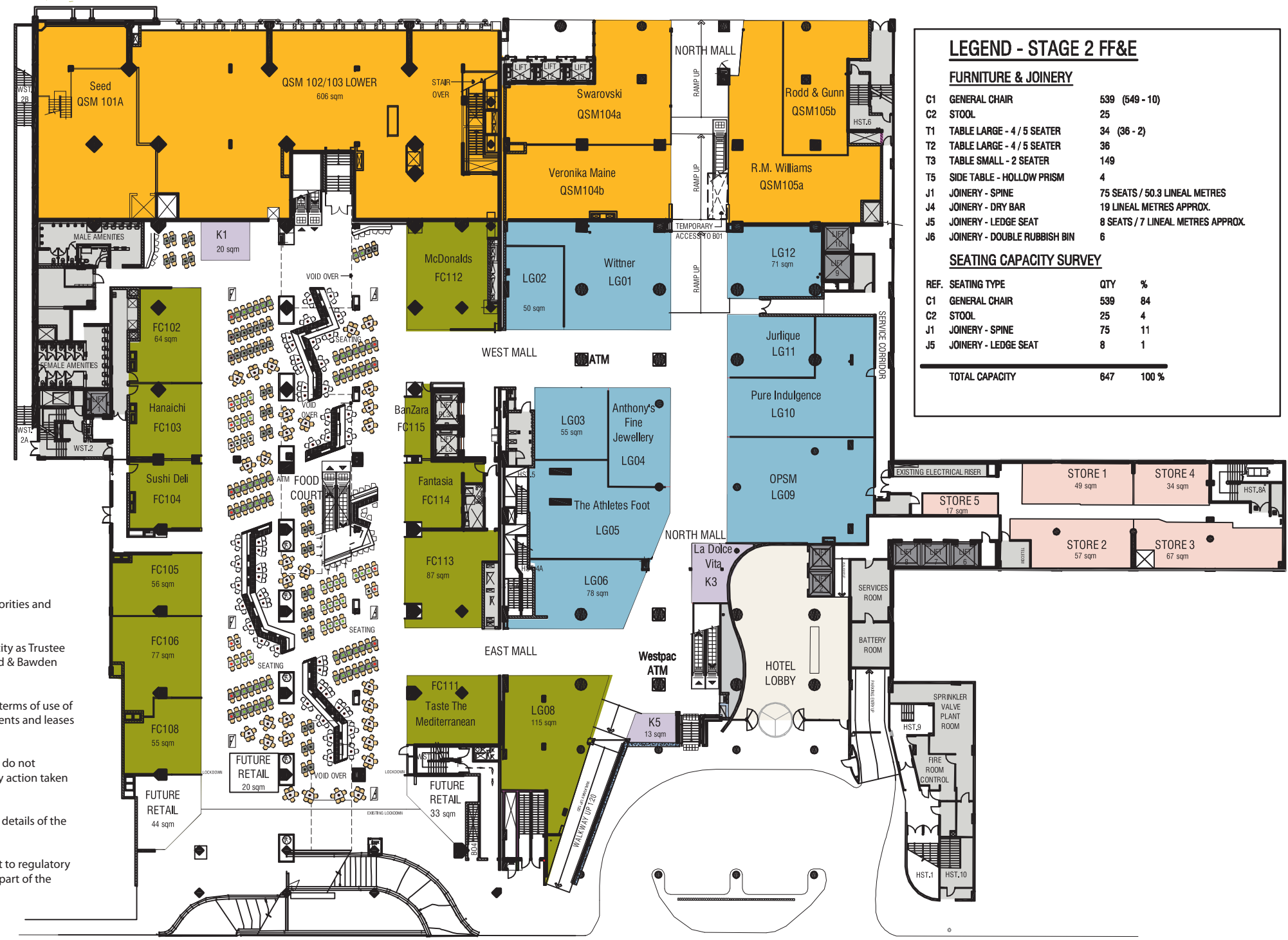

EDWARD STREET

Disclaimer

All areas and dimensions are subject to regulatory approval from all relevant authorities and final survey. Final details are yet to be confirmed. Release plan not to scale.

This release plan has been prepared by ISPT Pty Ltd (ACN 064 041 283) in its capacity as Trustee of the Industry Superannuation Property Trust No. 2 (we) and Malone Buchan Laird & Bawden (Architects).

This release plan is a guide only, does not constitute an offer and is subject to the terms of use of www.wintergardenbrisbane.com, any relevant retail shop lease disclosure documents and leases in respect of the premises depicted on this release plan.

Whilst all information has been gathered from sources we deem to be reliable, we do not guarantee the accuracy of this information, nor do we accept responsibility for any action taken by any party (including intending lessees) in reliance on this information.

All persons including intending lessees should make their own enquiries as to the details of the development.

All illustrations in relation to the development are conceptual only and are subject to regulatory approval from all relevant authorities. Changes may be made to the whole or any part of the development without notice.

25.02.2010

ELIZABETH STREET